

BUILD-TO-SUIT / PAD OPPORTUNITIES

St. Margaret's Square

5110 ST-MARGARET'S BAY ROAD, UPPER TANTALLON, NOVA SCOTIA

RETAIL



PROPERTY INFO

Upper Tantallon is an affluent suburb of Halifax and surrounded by upscale residential developments, schools, golf course, marina and several other community amenities.

Anchor tenants include Lawton's Drugs and Canadian Tire.

- + Approvals in place to build two pad sites. Pad A: 7,464 sq. ft. and Pad B: 18,700 sq. ft.
- + Overall parking ratio of 5.5:1
- + Highly-frequented site with medical services, food options and retailers
- + Easy access and strong visibility from St-Margaret's Bay and Hammonds Plains Road



www.cbre.ca



BUILD-TO-SUIT / PAD OPPORTUNITIES

St. Margaret's Square

5110 ST-MARGARET'S BAY ROAD, UPPER TANTALLON, NOVA SCOTIA

RETAIL

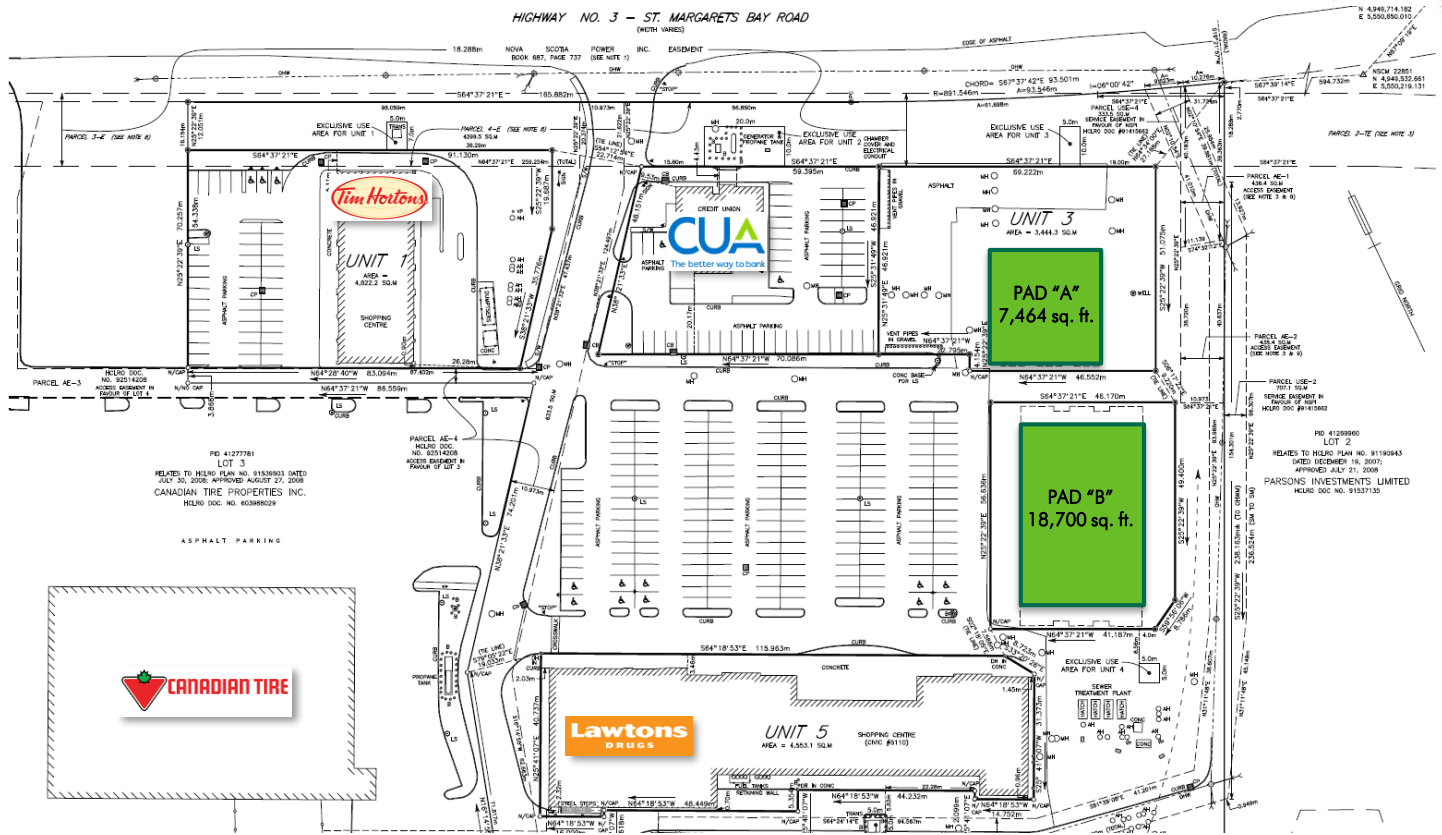

Upper Tantallon – 2018 Market Snapshot (within 10-km radius)

| | |
|----------------------------|-----------|
| • Population | 21,695 |
| • Median age | 41.9 |
| • Average household income | \$120,844 |
| • Number of households | 7,600 |

Major Tenants Nearby

- Atlantic Superstore
- Canadian Tire
- Lawton's Drugs

Additional Information

| | |
|-----------------------|--------|
| Distance to Halifax | 30 km |
| Average Daily Traffic | 15,000 |

CONTACT US

MAT HOUSTON

Associate Vice President
902.492.2074
mathew.houston@cbre.com

DONALD TABOR

Sales Representative
902.471.0481
donald.tabor@cbre.com

This disclaimer shall apply to CBRE Limited, Real Estate Brokerage, and to all other divisions of the Corporation; to include all employees and independent contractors ("CBRE"). The information set out herein, including, without limitation, any projections, images, opinions, assumptions and estimates obtained from third parties (the "Information") has not been verified by CBRE, and CBRE does not represent, warrant or guarantee the accuracy, correctness and completeness of the Information. CBRE does not accept or assume any responsibility or liability, direct or consequential, for the Information or the recipient's reliance upon the Information. The recipient of the Information should take such steps as the recipient may deem necessary to verify the Information prior to placing any reliance upon the Information. The Information may change and any property described in the Information may be withdrawn from the market at any time without notice or obligation to the recipient from CBRE. CBRE and the CBRE logo are the service marks of CBRE Limited and/or its affiliated or related companies in other countries. All other marks displayed on this document are the property of their respective owners. All Rights Reserved.



www.cbre.ca

